

### Connecting the Terminal Block

Connect main supply (brown - Live, blue - Neutral) into terminal block making sure all connections are tight.

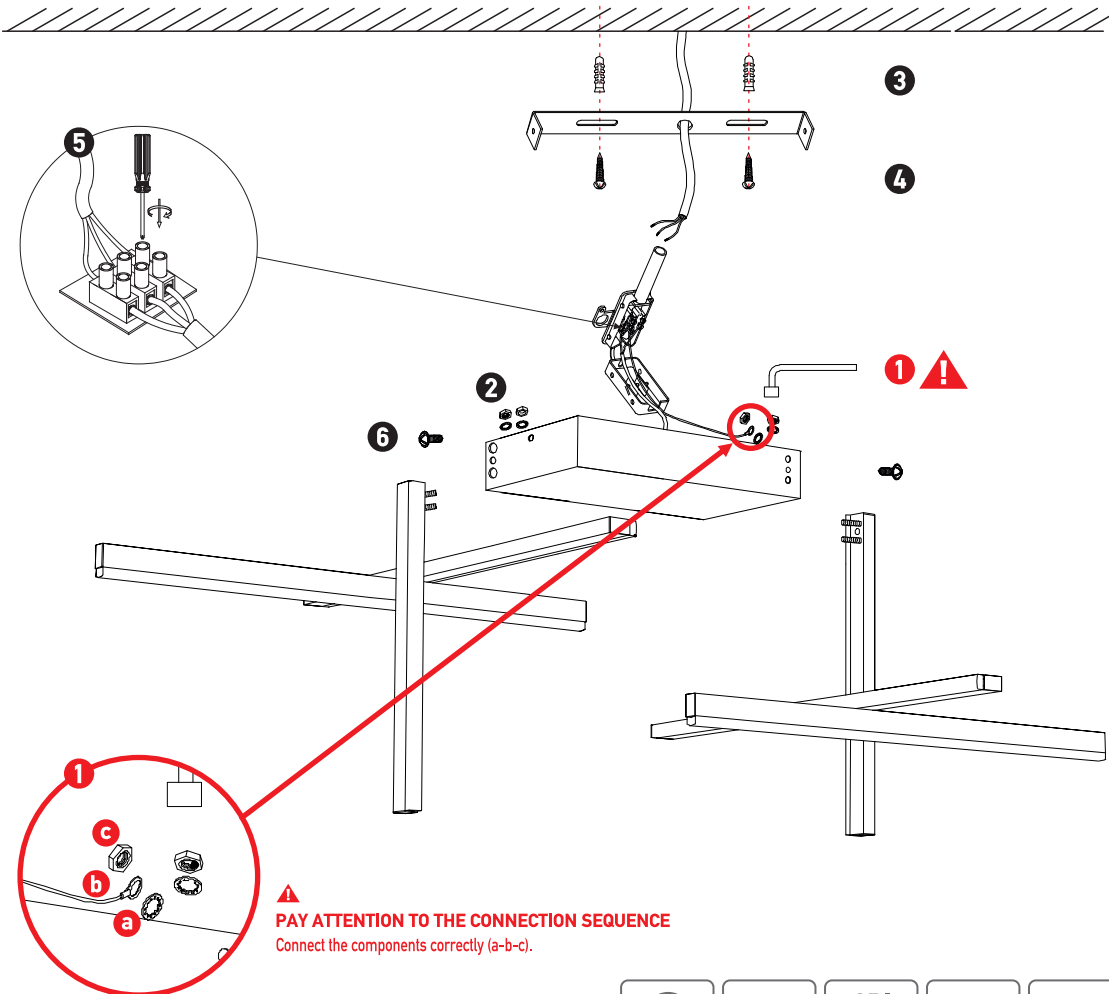

**⚠ PAY ATTENTION TO THE CONNECTION SEQUENCE**  
Connect the components correctly (a-b-c).

# CEILING LIGHT

# 22026

Please read instructions before commencing installation and retain for future reference.

### SPECIFICATIONS

- **Material:** Metal + Aluminum + Silicon
- **Lamp Type:** LED , 46W , 3000K , 4987Lm , CRI 80
- **Ingress Protection:** IP20. Protection against entry of solid objects greater than 12mm in diameter.

### INSTALLATION INSTRUCTIONS

**⚠** Electrical products can cause death, injury, or damage to property. Installation of this product must be carried out by a qualified electrician.

- Ensure main supply is switched off.
- Before mounting, connect the right piece of the lamp with the correct order (a-b-c) for the connection to the power supply with allen tool (1).
- Connect the left piece of the lamp with allen tool (2).
- Insert masonry plugs into mounting surface (3).
- Fit mounting bracket onto mounting surface with self-tapping screws (4).
- Connect main supply wires to terminal block (5) making sure all connections are tight.
- Fit ceiling plate onto mounting bracket with screws (6).
- Reconnect power.

### WARNING

- Make sure that the products is installed properly before connecting to electricity.
- Do not cover the fitting.
- Not for outdoor use or in wet conditions.

